

Office for rent in Castellana.

Ref. AOM2207020

Madrid / Chamartín

- ✓ Security
- ✓ A/C
- ✓ Heating
- ✓ Parking
- ✓ Condition: Very good



Price from 11,005 € | Surface 355 m² - 2039 m² | 6 Units

OFFICE IN REPRESENTATIVE AND EXCLUSIVE OFFICES BUILDING IN PLAZA CASTILLA. Exclusive and dedicated offices building located on the main artery of the city. The building has been adapted to the new trends of companies and people, becoming a sustainable building and Smart Building. Surrounded by all kinds of services and very well connected by both public and private transport; Atocha Station is a 15-minute drive away and is 13 minutes from Adolfo Suarez Airport. Can you imagine working here?

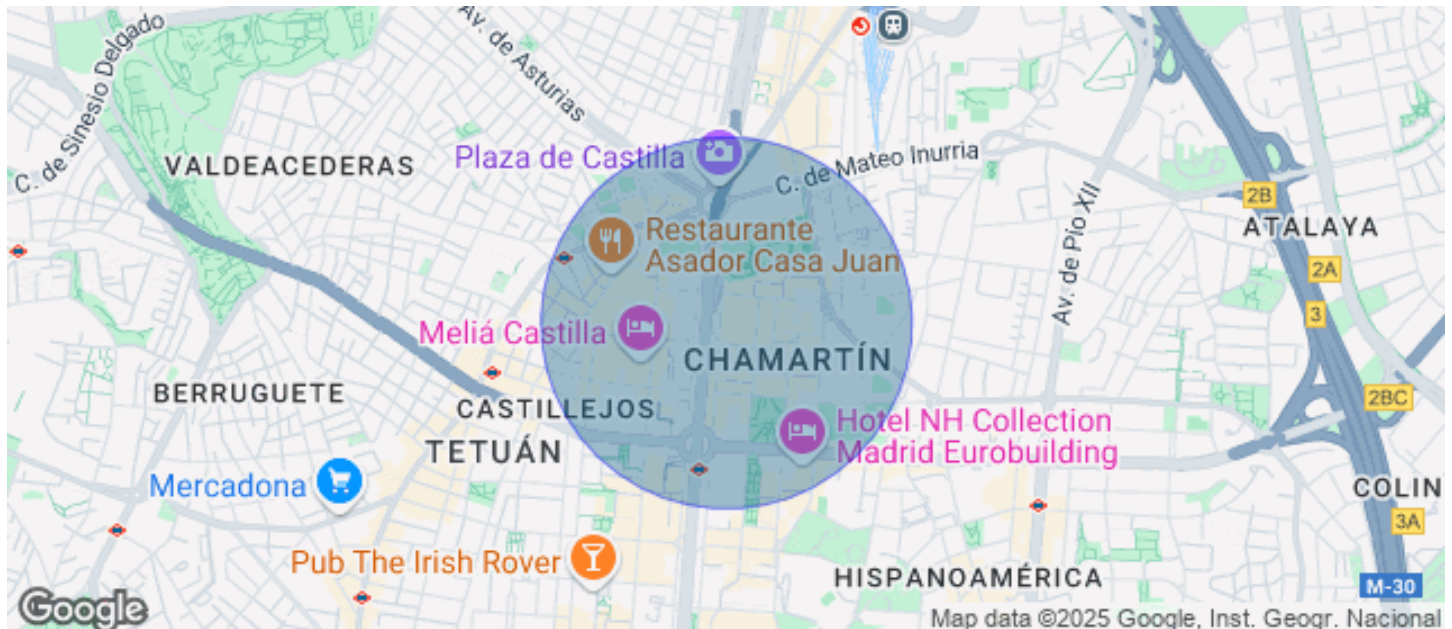

## Available offices in this building

Floor	Surface	Price	Price/m <sup>2</sup>	IBI	Charges	Availability
2º	1,524 m <sup>2</sup>	€48,768	32 €/m <sup>2</sup>	a consultar con la propiedad	7.04€/m2	Immediate
3º	2,039 m <sup>2</sup>	€65,248	32 €/m <sup>2</sup>	a consultar con la propiedad	7.04 €/m2	Immediate
4º A+B	512 m <sup>2</sup>	€15,878	31 €/m <sup>2</sup>	a consultar con la propiedad	7.04 €/m2	Immediate
4º C + D	559 m <sup>2</sup>	€18,454	33 €/m <sup>2</sup>	a consultar con la propiedad	7.04€/m2	Immediate
4º E	355 m <sup>2</sup>	€11,005	31 €/m <sup>2</sup>	a consultar con la propiedad	7.04€/m2	Immediate
5º E + F	1,308 m <sup>2</sup>	€41,845	32 €/m <sup>2</sup>	a consultar con la propiedad	7.04 €/m2	Immediate

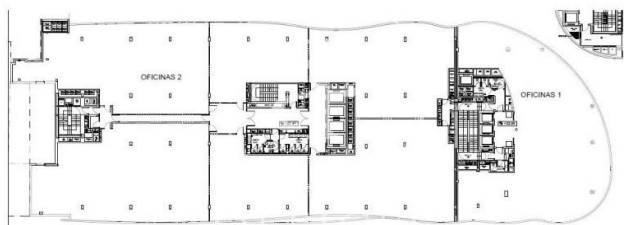
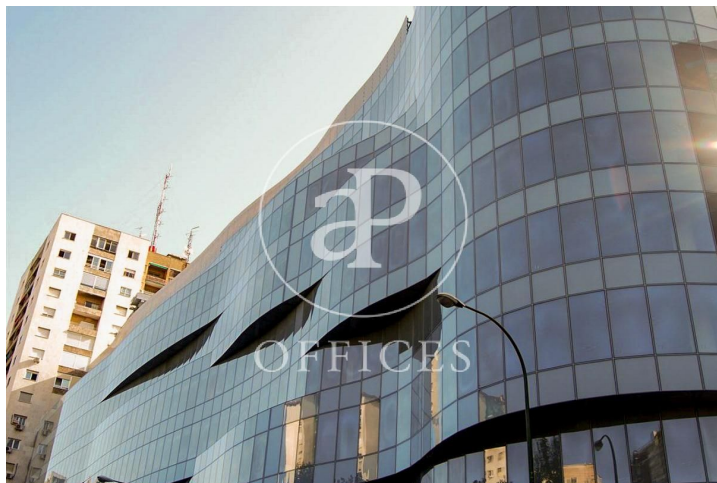

The information about any property is not binding to any offer or contract. Any verbal or written declaration made by aProperties with regards to the value or condition of the property should not be considered accurate or factual. The pictures make reference to some parts of the property at the times that they were taken. The areas, dimensions and distances that are given are approximate and should be checked by the client. The images are computer generated and are just an approximate indication of the real appearance of the property; these may change at any time. The information with regards to the property may also change at any time.

---

Contact us today for more information or to arrange a viewing

Tel: 91 800 54 65

[oficinasmad@aproproperties.es](mailto:oficinasmad@aproproperties.es)

[www.aoficinas.es](http://www.aoficinas.es)